

COVID-19 SAFETY GUIDE



MALZFABRIK EVENT

+49 30 755 17 125 • location@malzfabrik.de

We take our responsibility as location provider and service contractor very seriously. In the following pages, we will present to you our health and safety plan for events in Malzfabrik, to offer event organisers and guests full transparency in the measures we take. Based on this, one can assess one's own risks and enjoy a safe event at Malzfabrik.



© Malzfabrik | Fotograf: Matthias Friel

SPECIAL FEATURES OF THE LOCATION

› OUTDOORS AND INDOORS

The risk of infection is less outdoors than it is in enclosed rooms. Through wind or continuous ventilation, aerosols are carried away. Together, the Machine Hall (indoors) and the Roofed Patio (outdoors) event spaces offer an ideal combination of the spacious, ventilated indoor room, and a wide roofed outdoor space, and both can be used during the pandemic. It is possible to have guests in these spaces for planned programs such as presentations, meetings and lectures.

The Machine Hall has various exits which allow for secure visitor management during COVID-19. The entrance can be separated from the exit, and it is possible to set up one walking direction through all areas of the event. Signs advising visitors on safe distancing and direction provide fast and uncomplicated orientation. Because of our long-standing partnerships with suppliers, it is also possible to stretch a one-day event over two days without having to pay for the equipment a second day. That offers further possibility to host an event with a higher number of guests.

› STREAMING

To provide streaming at events, a stabile cable with up to 500 Mbit/s is available. It creates a way for family members from high-risk groups to participate digitally. For this, we have a range of camera equipment and available set-ups, including cost-free steaming via social media platforms or fee-based streaming via host sites. You can also extend this offer to provide a video recording of the event.



MASCHINENHALLE AND ZWISCHEN-DACH AS SPACES TO STAY

The furniture's layout makes it possible for guests to maintain a safe distance of 1,5 metres. All personnel wear masks. At information points, wall partitions are permanently installed in order to protect participants.

Surfaces that are touched by guests are regularly cleaned and disinfected. All entrances to further spaces stay open in order to reduce the use of door handles. We recommend that all events include a moderator to help guests navigate the schedule and safety measures. This can help to avoid close encounters. If product presentations or participation stations are included in an event, all displays and devices are disinfected after each use.



MASCHINENHALLE AND ZWISCHENDACH

EXAMPLE 1

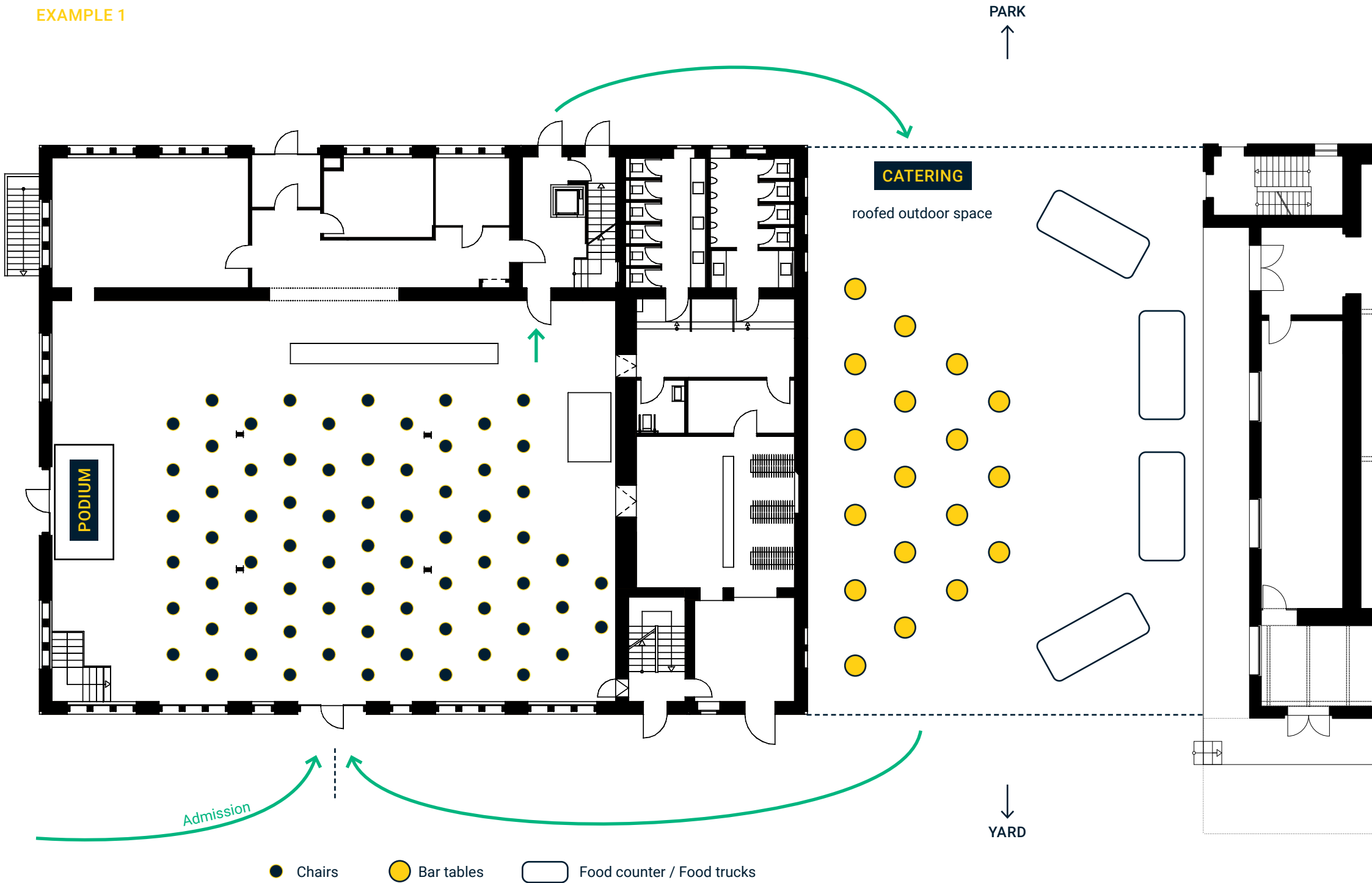

MASCHINENHALLE AND ZWISCHENDACH

EXAMPLE 2





PERSONNEL MANAGEMENT

Event personnel have to observe the following daily schedule:

- › washing and disinfecting hands before starting work
- › COVID-19 safety representatives of Malzfabrik will keep a list registering employee attendance times
- › before the start of work all employees will sign a waiver of data law provisions for COVID-19 restrictions, and allow a collection of all data for a time frame of 4 weeks
- › at registration all employees will receive a briefing about the COVID-10 SAFETY GUIDE
- › all personnel is instructed to wear masks
- › if an employee develops symptoms, he/she has to leave Malzfabrik immediately
- › all personnel have to observe the hygiene recommendations and the minimum distance of 1,5m during construction and deconstruction phases. In situations where safe distancing is not possible, the use of a mask is advised
- › all bathrooms and other hand contact surfaces are regularly disinfected, including those under construction
- › additionally, all rooms have ventilation systems to guarantee constant air circulation



COVID-19

SAFETY REPRESENTATIVE

Social distancing and other safety measurements are easily forgotten during an event. To guarantee that measurements remain consistently observed, a safety representative of Malzfabrik is installed to help personnel and visitors alike. He/she instructs employees during the preparations and is on site during the event as a house representative.

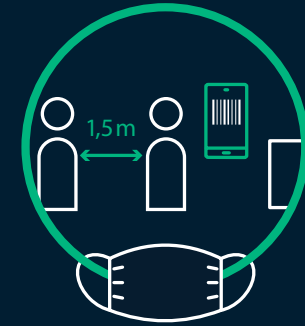

GUEST MANAGEMENT

As soon as all crews are on standby before the start of an event, all surfaces are cleaned. The personnel wear a mask to guarantee the safety of all guests. Ideally, participants should arrive at Malzfabrik in stages.

The inner yard of Malzfabrik offers enough space for guests to form queues with 1,5 m social distancing on a red carpet at the entrance area of the Machine Hall. Before entering the event space, all guests are advised to disinfect their hands. A disinfection station is at hand for this purpose.

We recommend using the yard area for accreditation purposes. At accreditation, each guest's attendance times are recorded on a registration list. Guests sign the waiver of data protection regulations because of COVID-19, and allow the storage of said collected data for 4 weeks. At registration, all guests receive a briefing about the COVID-10 SAFETY GUIDE of Malzfabrik. If a guest shows symptoms he/she is not allowed entry to the event space.

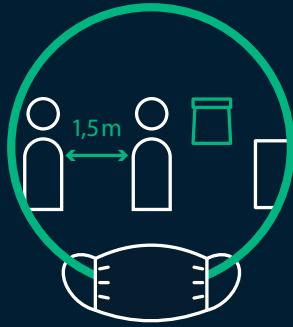

CATERING

For catering, we recommend handing out beverages and lunch bags of finger food from a delivery stand. The distribution and consumption of food can take place in a well ventilated indoor area, or the roofed outer area. We recommend dividing guests into smaller groups, in order to avoid close encounters. Personnel wear face masks and hand out food and drink from behind a transparent partition screen. Arranging several food delivery stands will make it possible to maintain 1.5 m social distancing. Dishes and kitchen equipment are heated to a minimum of 70 degrees Celsius before use.



SUSTAINABILITY

Surgical-standard mouth- and nose masks are comprised of polypropylene, an environmentally hazardous material. Because of its high rubber content, it is not recyclable and should be only used in a hospital setting. The use of sustainable masks made of linen or cotton from suppliers like [Sansirro](#), [Phyne](#) and [ArmedAngels](#) is recommended. For disinfectants, we recommend using agents with organic ingredients that are gentle to the environment and your hands.

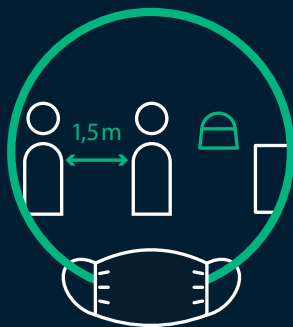

CLOAKROOM

In spaces where direct contact is unavoidable, like in the accreditation area and the cloakroom, a face mask and gloves for the employees and the transparent partition screen will take care of the safety of guests and employees. A maximum of three guests, standing at least 1,5m apart, will be served in the cloakroom. Visitors are then advised to immediately move on to the surrounding event spaces.



BATHROOMS

Entrances to the washrooms are supervised, allowing access to visitors observing safe social distancing rules. Sanitary supervision ensures that toilet seats, hand contact surfaces and floors are regularly disinfected.

GROUND VIEW

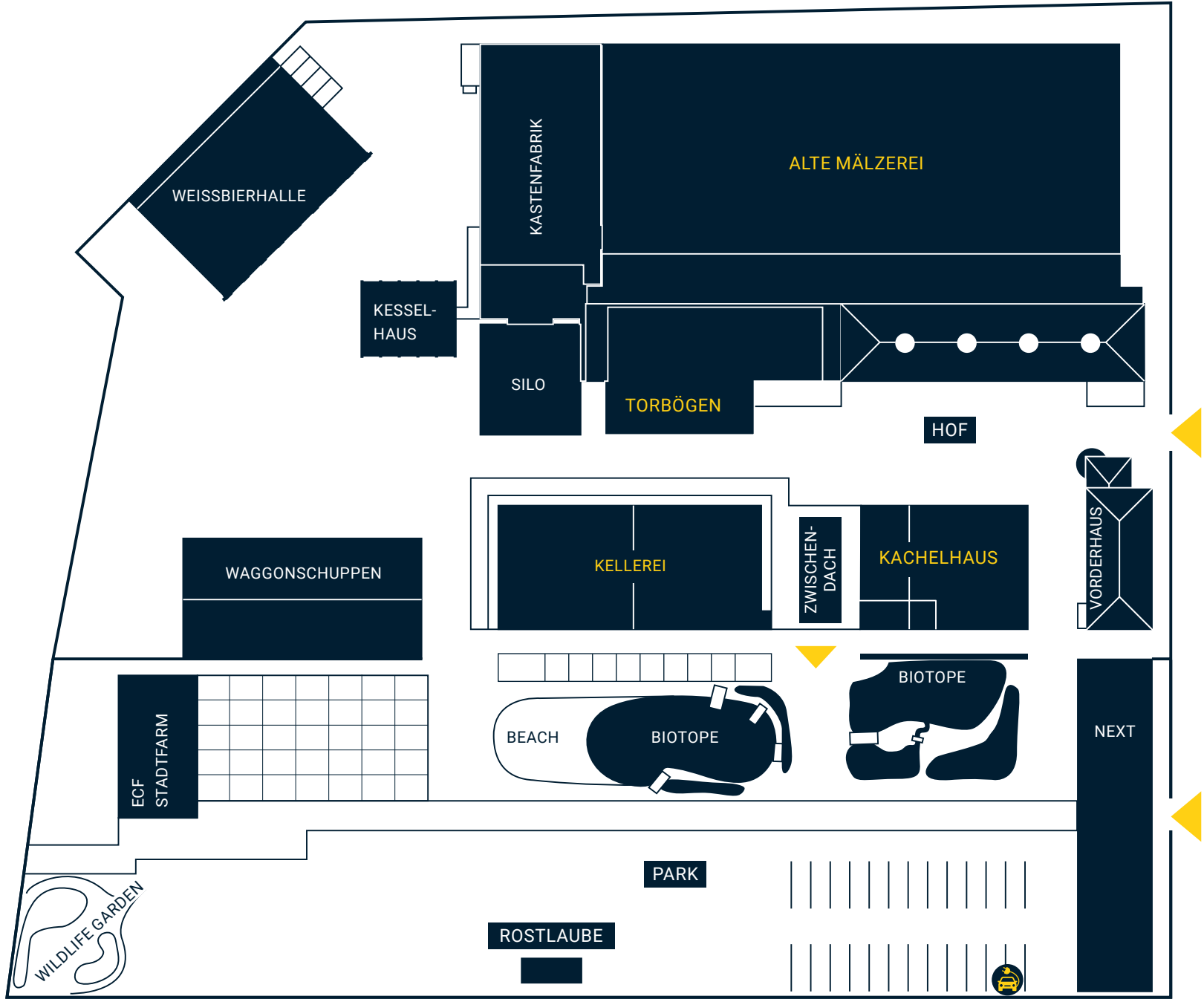

KACHELHAUS

- › Maschinenhalle ↗
- › Speicher ↗
- › Studio ↗
- › Lichtkeller ↗
- › Tankraum ↗
- › Sonnendeck ↗

ALTE MÄLZEREI

- › Besondere Räume ↗
- › Hallen ↗
- › Treppen ↗
- › Gänge ↗

OUTDOORS

- › Park ↗
- › Rostlaube ↗
- › Hof ↗
- › Zwischendach ↗
- › Torbögen ↗

APPROACH

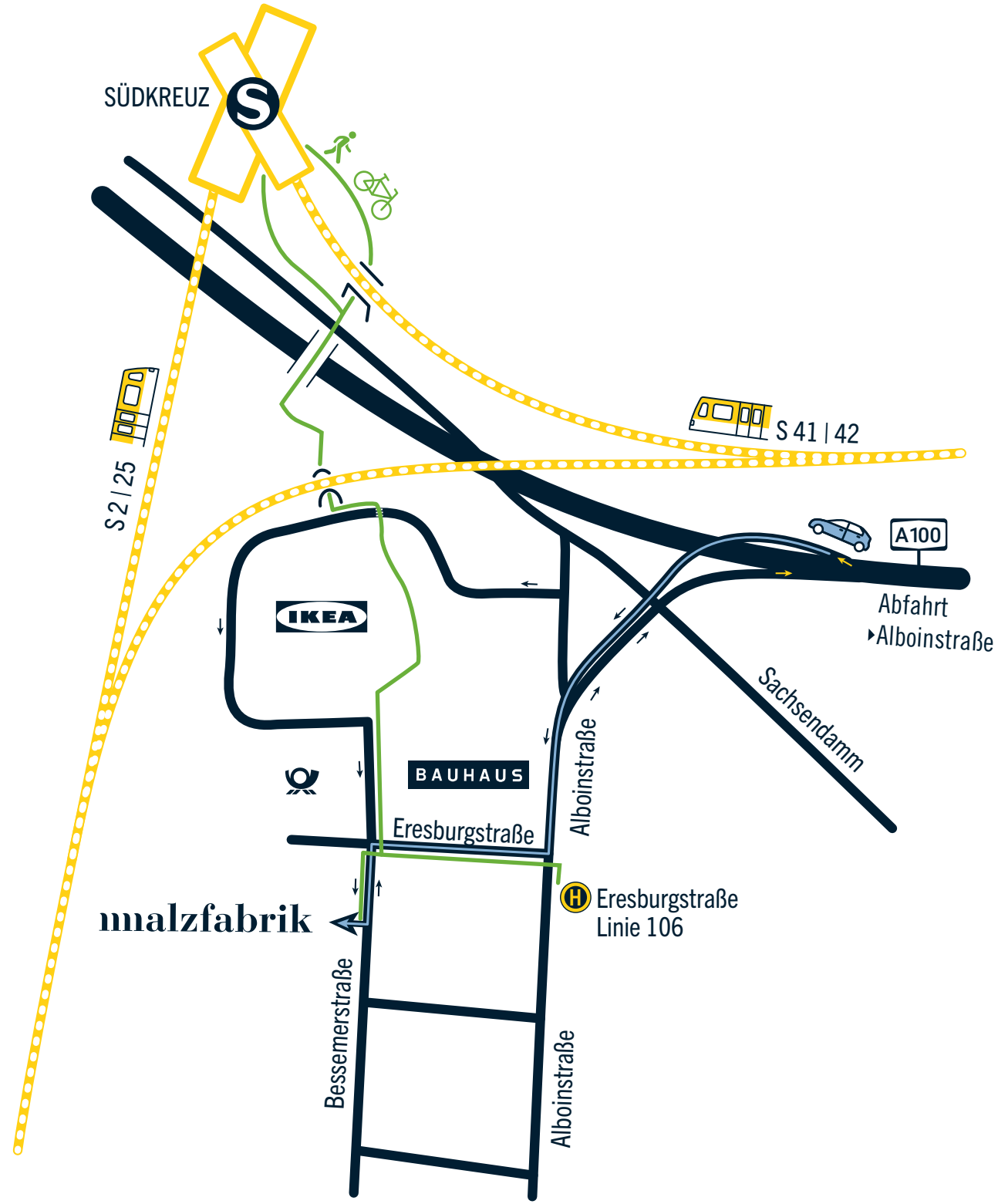

STAY HEALTHY!

You can reduce the risk of infection to a minimum
with the COVID-10 SAFETY GUIDE.

We look forward to supporting you with these
safety measures, and to many unforgettable events.



MALZFABRIK EVENT



Bessemerstr. 2-14 | 12103 Berlin



+49 30 755 17 125



malzfabrik-event.de



location@malzfabrik.de